



INSTALLATION GUIDE | 10.2022

## UA200117-C Titleist Trufeel cart

# INFORMATION

## Installation package



Left side panel (x1)



Back frame (x1)



Base (x1)



Right side panel (x1)



Wheel (x2)



Graphic (x1)



Card board (x1)



Handle (x1)



Lock nut (x2)



Washer (x4)



M5 screw (x14)



Big wrench (x1)



L shape wrench (x1)

# OVERVIEW



## Installation Instructions



1

Open the packaging to take out all the parts.



2

Insert the back frame into the base.

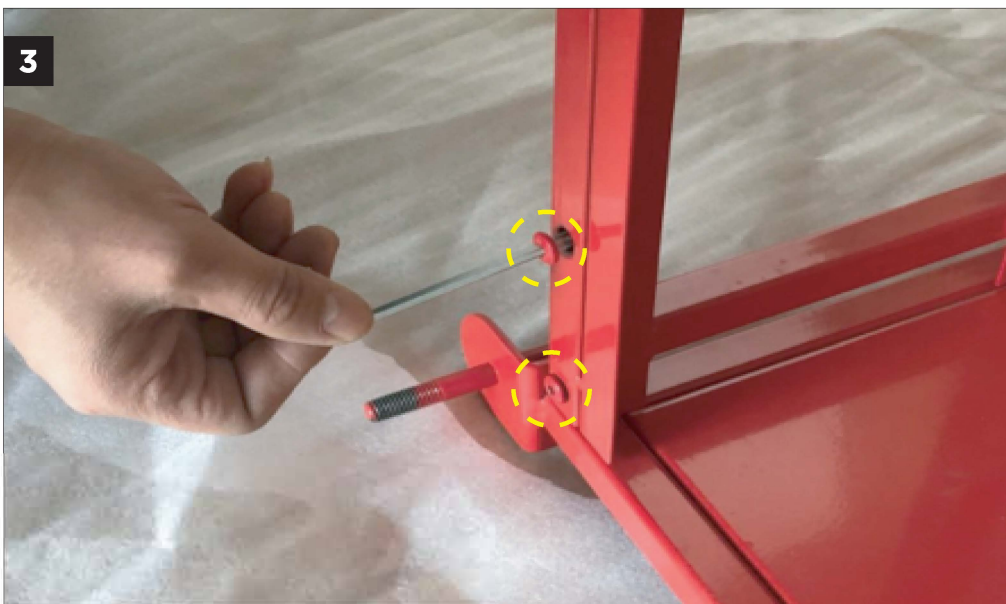

3

Screw in 2 screws on both sides to secure.



4

Slide washer on bolt.

## Installation Instructions



5

Install the wheel and washer.



6

Screw in lock nut.



7

Install the left and right side panel, screw in 2 screws on top and bottom of both sides with wrench provided.



8

Secure the handle by fastening a screw on each side.

## Installation Instructions



9

Open up the supporting cardboard matrix and place in the center of the box.



10

Bend the long sides and cover the matrix.



11

Peel back one corner of each yellow tape and fold up the ends aligning the edges.



12

When satisfied all sides are square, remove the yellow tape and press sides together firmly.

## Installation Instructions

13



Install in the unit with the seam facing the back.

14



Insert the graphic to finish installing.

15

**IMPORTANT**-Once the installation is complete please scan the QR code below or on the display to register this display

